

JMA Weather Protection System™

WPS-2F-12, for 1/2" 2.2-5 Connector to Port



Materials (all sold separately)



WPS-2F-12
(2) 2.2-5 port seals



WPS-LWJ
weatherproofing boot



L-2M-12
2.2-5 connector



TQ-916-F2.2
torque wrench

Step 1: Connect and torque interface



Mate the male connector to the port.



Torque the connector to 2.2 lbf-in using the TQ-916-F2.2 torque wrench.

WPS-2F compatible port specification

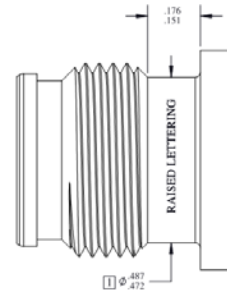

Step 2: Install JMA WPS to seal interface



Slide the WPS-LWJ over the port seal until ribs are no longer visible.



Properly installed WPS-LWJ.
NOTE: all ribs of the port seal are fully covered by the WPS.

1 Surface to be free of flats, threads, or raised lettering whose characters are taller than 1/16".

JMA Weather Protection System™

WPS-2F-12, for 1/2" 2.2-5 Connector to Port



Materials (all sold separately)



WPS-2F-12
(2) 2.2-5 port seals



WPS-N-4A or WPS-N-4S
weatherproofing boot



UXP-2MT-12
2.2-5 connector



TQ-916-F2.2
torque wrench

Step 1: Install WPS-N-4A (or WPS-N-4S) and port seal



Prior to cable prep, slide the WPS-N-4A (or WPS-N-4S) boot onto the 1/2" cable 8–12" from the end.



Prep the 1/2" cable and install the JMA 1/2" 2MT connector. Refer to the connector installation instructions.



Install port seal with tapered side toward the nut. Seal is black in color.

Step 2: Connect and torque interface



Mate the male connector to the port.

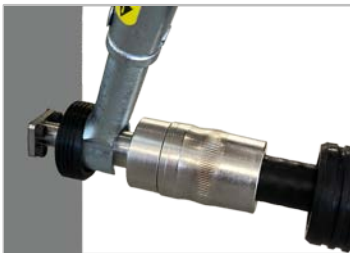

Torque the connector to 2.2 lbf-in using the TQ-916-F2.2 torque wrench.

WPS-2F compatible port specification

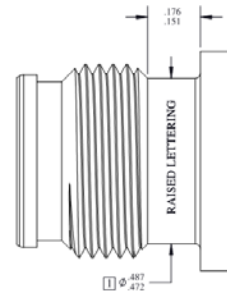

Step 3: Install JMA WPS to seal interface



Slide the WPS-N-4A (or WPS-N-4S) boot over the port seal until ribs are no longer visible.



Properly installed WPS-N-4A (or WPS-N-4S). **NOTE:** all ribs of the port seal are fully covered by the WPS.

- 1** Surface to be free of flats, threads, or raised lettering whose characters are taller than 1/16".