

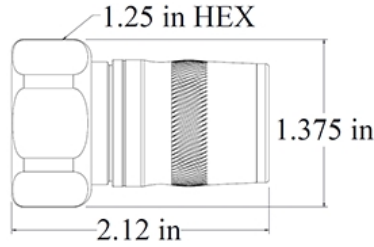

# UXP-DM-12L

## 7-16 DIN Male Connector for LS LHF12D Cable



[Installation video](#)



[Installation instructions](#)



Contact technical support:

1-888-201-6073

[techsupport@jmawireless.com](mailto:techsupport@jmawireless.com)

General		Specification	
Interface/gender	7-16 Male		
Cables supported <sup>1</sup>	Manufacturer	P/N	
	LS/Superior Essex	LHF 12D	
Weight	141 g   0.311 lb		
JMA Weather Protection System	WPS-4A		

Tools required	JMA part number	Comment
Cable preparation	SP-1/2-LH4D	"U" bit
Connector compression	HCG-FRAMESET-1/2, HCG-CC	Insert A
Torque wrench	TQ-114-F18	18 lbf-ft   24.4 N·m

Frequency band	VSWR	Return loss (dB)
DC-1000 MHz	1.02	40
1000-2000 MHz	1.03	36
2000-4000 MHz	1.05	32
4000-6000 MHz	1.08	28

Electrical	Specification	Comment
Connector impedance	50 ohm	
Operating frequency band	DC-6 GHz	
3rd order IMD dynamic, (PIM)	-161 dBc, typical	IEC 62037-2
DC test voltage	4000 V	
Center contact resistance	≤0.4 milliohm	
Outer contact continuity	1.50 milliohm max.	
Average power	1100 W @ 900 MHz	
Peak power, max.	40 kW	
Insertion loss, typical	0.05 dB	Per connector
Shielding effectiveness	< -120 dB	@ 0-1 GHz

Mechanical	Specification	Comment
Pull force combined	0.9 kN   >200 lb	Cable limited
Cable retention torque	6.7 N·m   5 lbf-ft	Cable limited
Interface durability	500 cycles	IEC 61169-4:9.5

Environmental	Specification	Test
Operating temperature	-55 °C to +85 °C (-67 °F to 185 °F)	
Storage temperature	-55 °C to +85 °C (-67 °F to 185 °F)	
Accelerated UV	1000 hr	ASTM G154
Immersion test method	Mated & unmated, IP68	IEC 60529:2001 & ANSI/SCTE 60
Water jetting test method	Mated & unmated, IP66	IEC 60529:2001
Mechanical shock test method	Pass	IEC 60068-2-27
Thermal shock test method	Pass	IEC 60068-2-14
Vibration test method	100 m/s <sup>2</sup> , 2 Hz to 200 Hz	IEC 61169-1:2003
Corrosion test method	1000 hr	IEC 60068-2-11

<sup>1</sup>For cable types not listed, please contact JMA Technical Support.

