

# JMA Weather Protection System™

WPS-1MT-14S, for 1/4" Nex10 Connector to Port



## Materials (all sold separately)



**WPS-1MT-14S**  
weatherproofing boot



**WPS-1F**  
(2) Nex10 port seals



**UXP-1MT-14S**  
Nex10 connector



**TW-716-F3.7**  
torque wrench

## Step 1: Install WPS-1MT-14S and port seal



Prior to cable prep, slide the WPS-1MT-14S boot onto the 1/4" cable 8–12" from the end.



Prep the 1/4" cable and install the JMA 1/4" 1MT connector. Refer to the connector installation instructions.



Install port seal with text facing away from the nut. Seal is black in color.

## Step 2: Connect and torque interface



Mate the male connector to the port.



Torque the connector to 3.7 lbf-ft using the TW-716-F3.7 torque wrench.

### WPS-1F compatible port specification

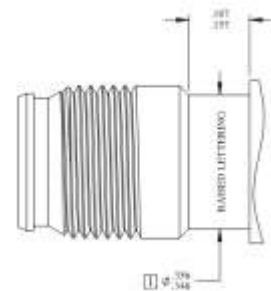

## Step 3: Install JMA WPS to seal interface



Slide the WPS-1MT-14S over the port seal until ribs are no longer visible.



Properly installed WPS-1MT-14S.  
**NOTE:** all ribs of the port seal are fully covered by the WPS.

- 1 Surface to be free of flats, threads, or raised lettering whose characters are taller than 1/16".